



# MAGNOLIA

---

## FLOOR PLATES



All floor plans, renderings, and illustrations are for marketing purposes only and are subject to change without notice. Dimensions, square footage, layouts, and configurations are approximate and may vary from actual construction. Furniture, appliances, and decorative elements shown are for illustrative purposes only and are not included in the purchase unless expressly stated. Developer reserves the right to modify plans, specifications, materials, and features without prior notice or obligation. All information is believed accurate but not guaranteed; interested parties should verify details independently. For complete specifications and the legally binding description of your unit, please refer to your executed Sale and Purchase Agreement.

THIRD FLOOR

RESORT SUNSET

FOURTH FLOOR

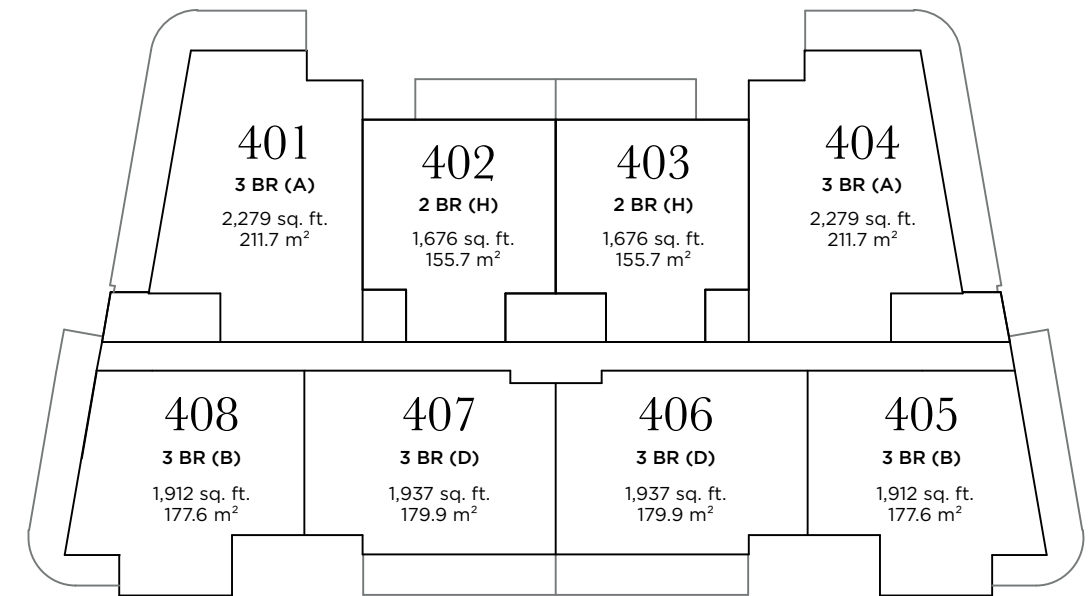
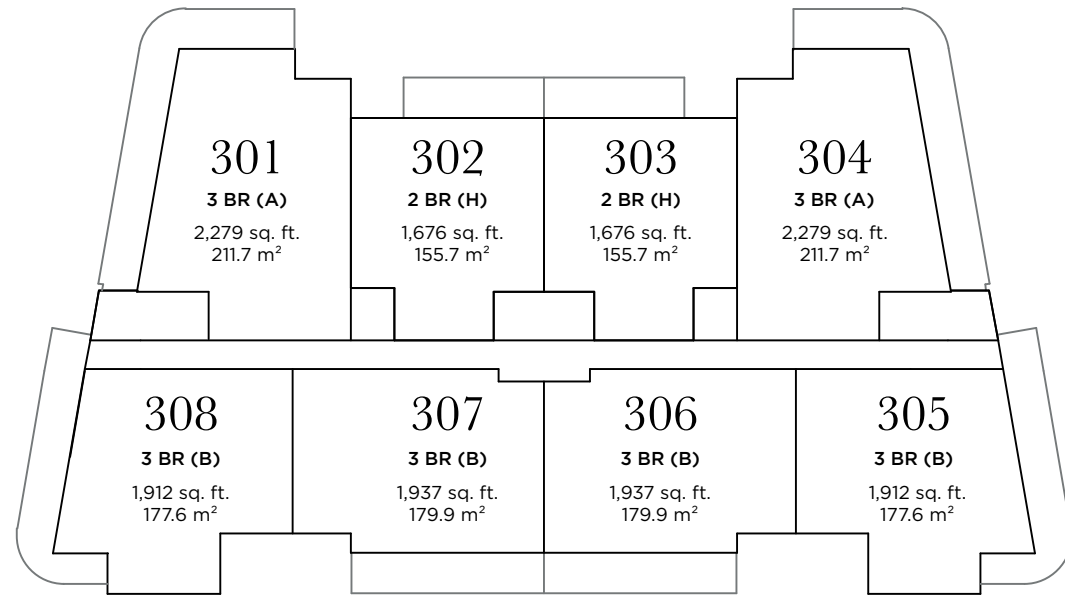

GROUND FLOOR

SECOND FLOOR

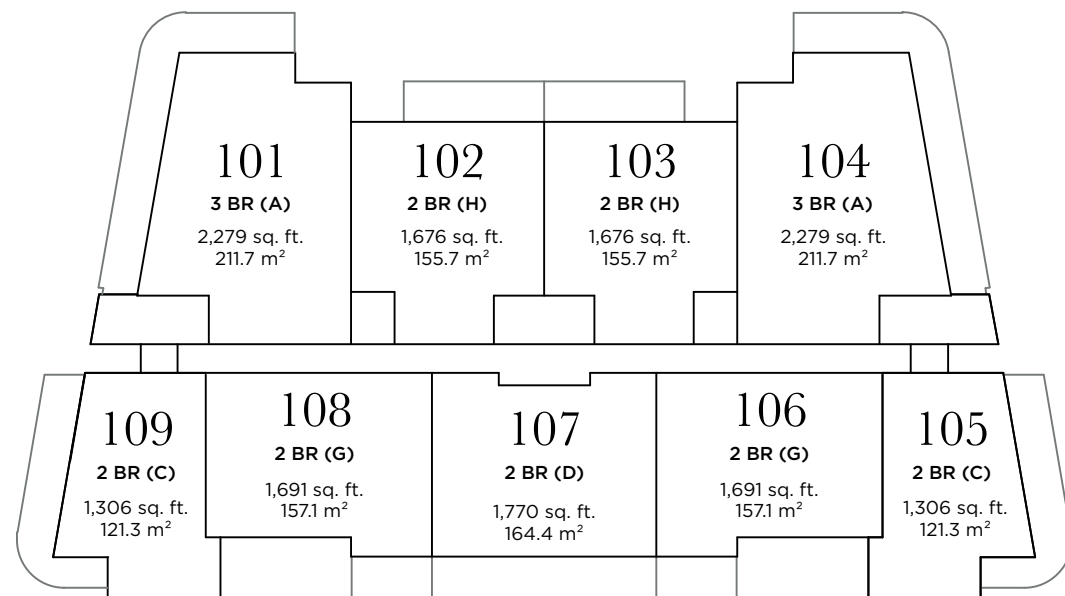

MARINA SUNRISE

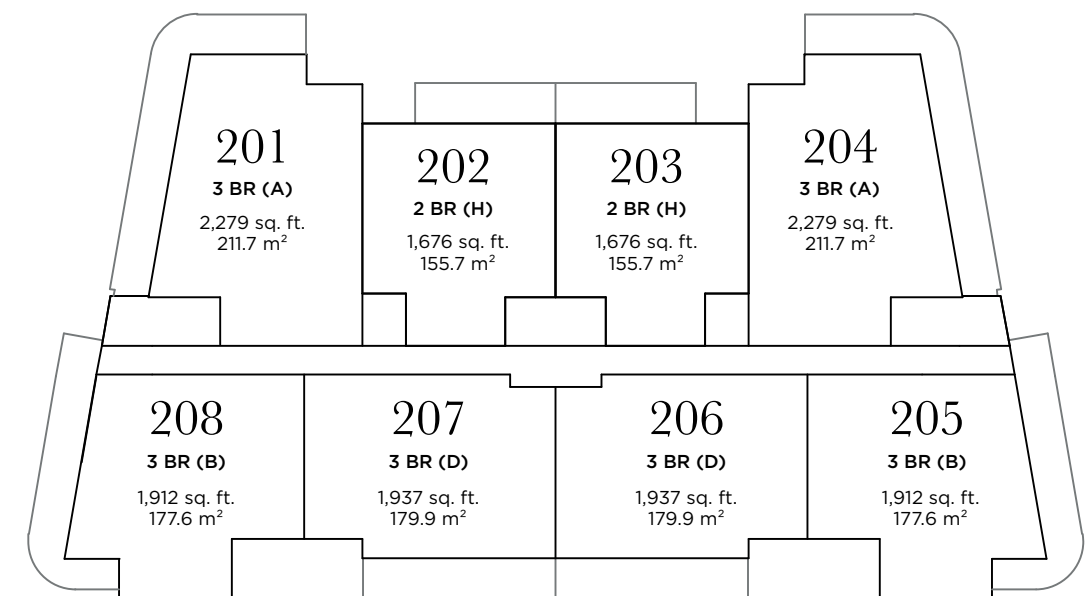

BUILDING

MAGNOLIA (R2)

TOTAL NUMBER OF RESIDENCES

33

UNIT MIX

2 BEDROOM (13) & 3 BEDROOM (20)

PLAN TYPES

7

NIKKI BEACH  
RESIDENCES  
*Antigua*

All floor plans, renderings, and illustrations are for marketing purposes only and are subject to change without notice. Dimensions, square footage, layouts, and configurations are approximate and may vary from actual construction. Furniture, appliances, and decorative elements shown are for illustrative purposes only and are not included in the purchase unless expressly stated. Developer reserves the right to modify plans, specifications, materials, and features without prior notice or obligation. All information is believed accurate but not guaranteed; interested parties should verify details independently. For complete specifications and the legally binding description of your unit, please refer to your executed Sale and Purchase Agreement.



- VILLA ENCLAVE:
- |            |              |
|------------|--------------|
| 1. APRA    | 5. ALLAMANDA |
| 2. CASSIA  | 6. MAHOGANY  |
| 3. MARANTA | 7. ZAMIA     |
| 4. ORCHID  |              |

# PLUMERIA

---

## FLOOR PLATES



All floor plans, renderings, and illustrations are for marketing purposes only and are subject to change without notice. Dimensions, square footage, layouts, and configurations are approximate and may vary from actual construction. Furniture, appliances, and decorative elements shown are for illustrative purposes only and are not included in the purchase unless expressly stated. Developer reserves the right to modify plans, specifications, materials, and features without prior notice or obligation. All information is believed accurate but not guaranteed; interested parties should verify details independently. For complete specifications and the legally binding description of your unit, please refer to your executed Sale and Purchase Agreement.

THIRD FLOOR

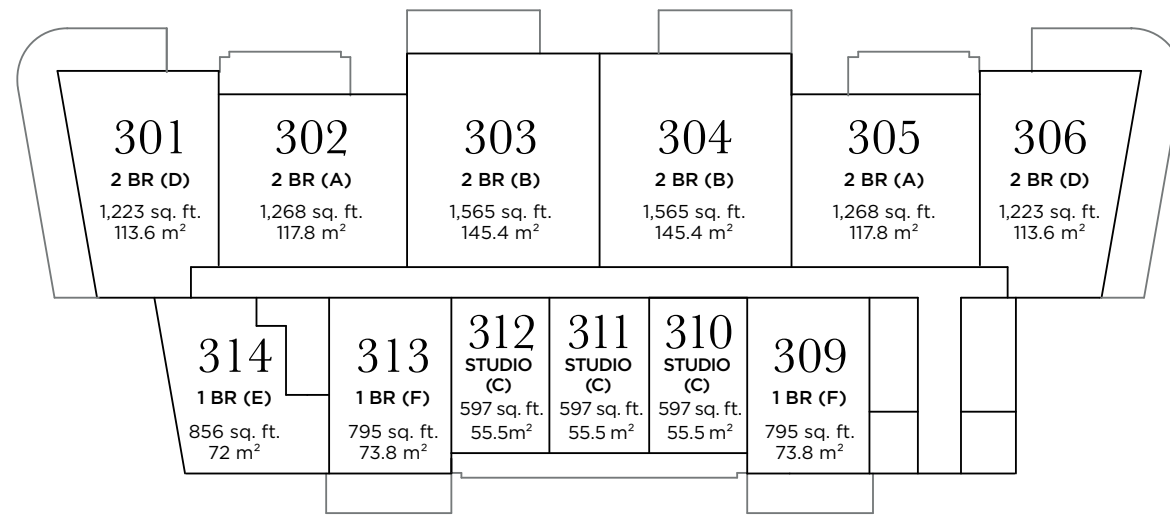

RESORT SUNSET

FOURTH FLOOR

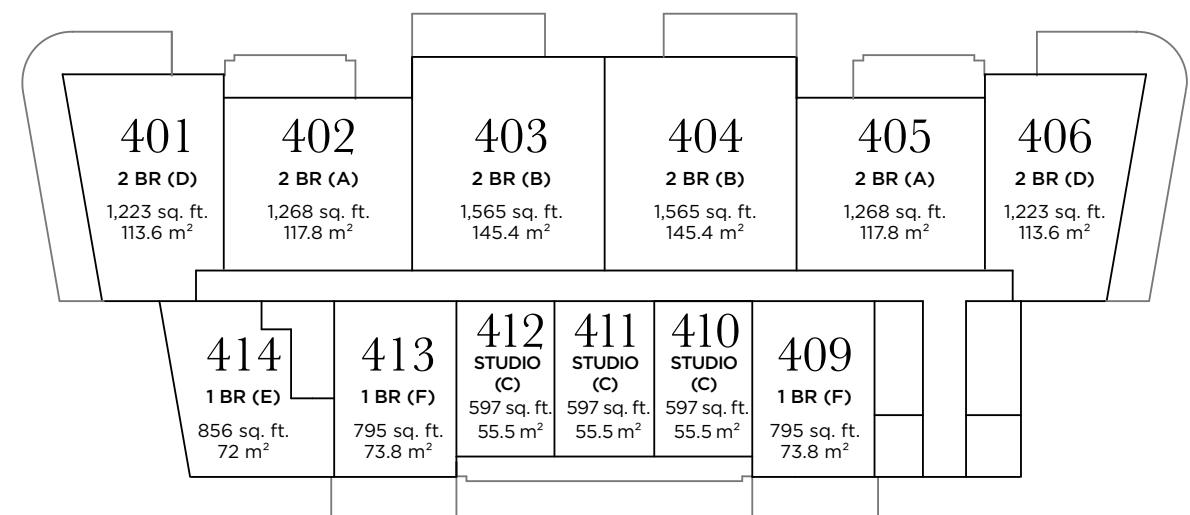

GROUND FLOOR

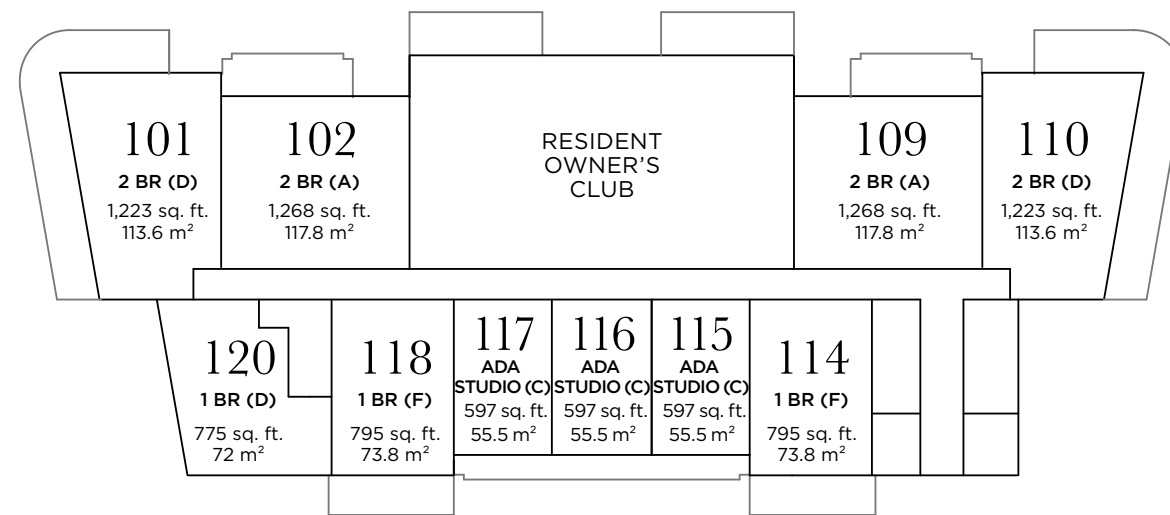

MARINA SUNRISE

SECOND FLOOR

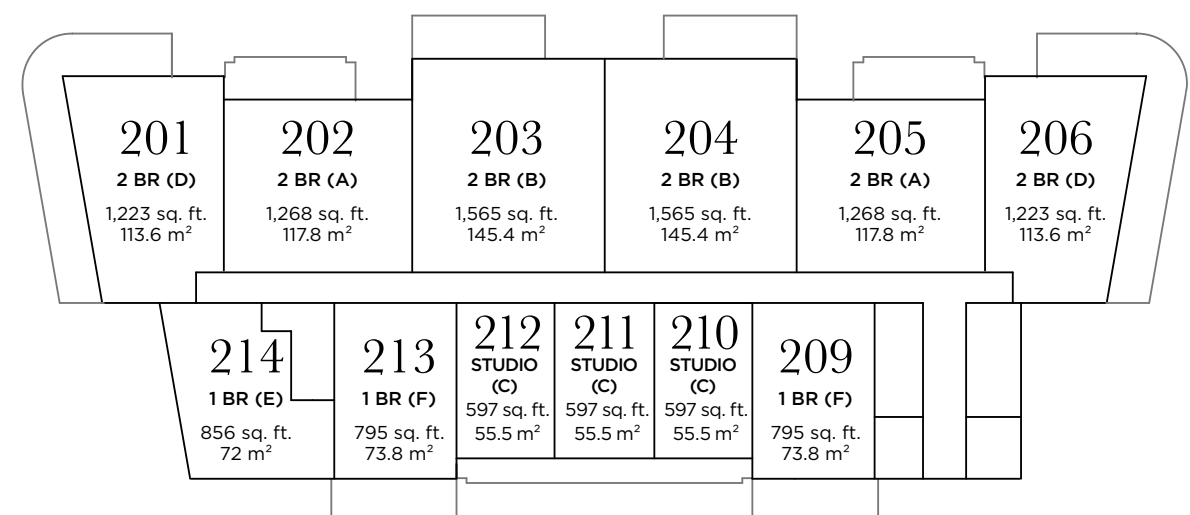

BUILDING

PLUMERIA (R3)

TOTAL NUMBER OF RESIDENCES

46

UNIT MIX

STUDIO (12), 1 BEDROOM (12) & 2 BEDROOM (22)

PLAN TYPES

8

NIKKI BEACH  
RESIDENCES  
*Antigua*

All floor plans, renderings, and illustrations are for marketing purposes only and are subject to change without notice. Dimensions, square footage, layouts, and configurations are approximate and may vary from actual construction. Furniture, appliances, and decorative elements shown are for illustrative purposes only and are not included in the purchase unless expressly stated. Developer reserves the right to modify plans, specifications, materials, and features without prior notice or obligation. All information is believed accurate but not guaranteed; interested parties should verify details independently. For complete specifications and the legally binding description of your unit, please refer to your executed Sale and Purchase Agreement.